

# Oil-less Rotary Scroll Medical Compressor Systems

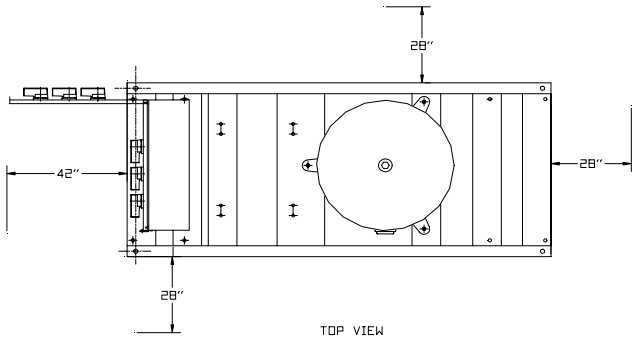

TOP VIEW  
28" MINIMUM CLEARANCE FOR EASE OF MAINTENANCE

DIMENSIONS						
MODEL	DIM. A	DIM. B	DIM. C	DIM. D	DIM. E	DIM. F
MSD0203	32"	74"	69"	1/2"(F)	38"	3/4"(F)
MSD0303	32"	74"	69"	1/2"(F)	38"	3/4"(F)
MSD0503	32"	74"	69"	1/2"(F)	38"	3/4"(F)
MST0503	32"	74"	69"	1/2"(F)	38"	1"(F)
MSQ0504	32"	79"	79"	3/4"(F)	38"	1-1/2"(F)

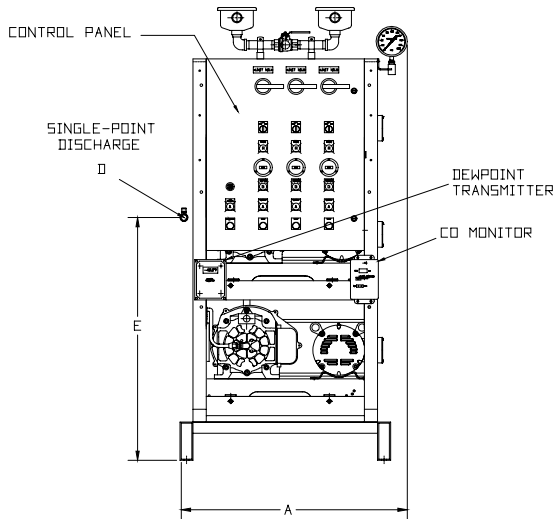

FRONT VIEW

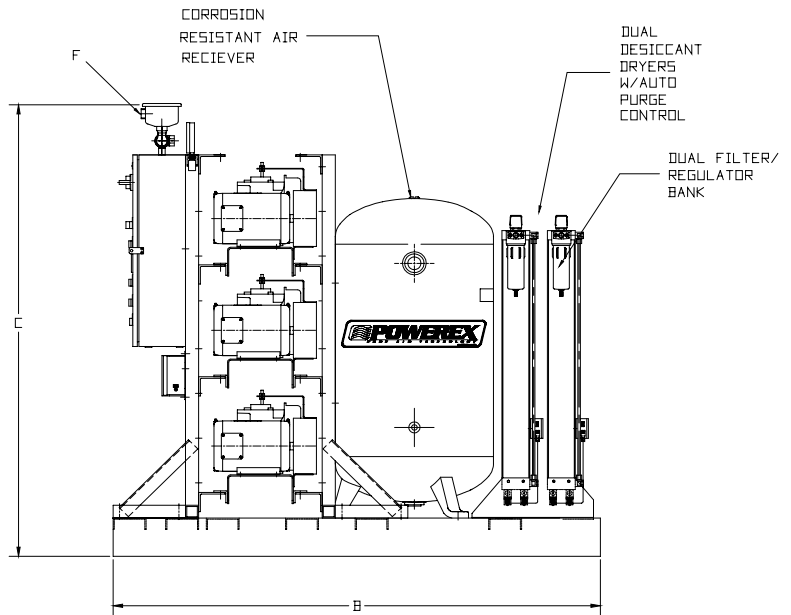

SIDE VIEW

MEDICAL SCROLL AIR COMPRESSOR SYSTEM - TECHNICAL DATA							
MODEL	TANK SIZE	BTU/HR <sup>1</sup>	dB(A) <sup>2</sup> LEVEL	SYSTEM F.L.A.			WEIGHT Lbs.
				208V	230V	460V	
MSD0203	80 gal.	4,020	65	15.6	13.6	6.8	1,325
MSD0303	80 gal.	6,525	69	22	19.2	9.6	1,325
MSD0503	80 gal.	11,105	70	27.4	26.4	13.2	1,425
MST0503	80 gal.	22,210	72	41.1	39.6	19.8	1,800
MSQ0504	120 gal.	33,315	74	54.8	52.8	26.4	2,175

1) - BTU/HR is shown with reserve compressor module(s) on standby

2) - dB(A) is shown with reserve compressor module(s) on standby

# Oil-less Rotary Scroll Medical Compressor Systems

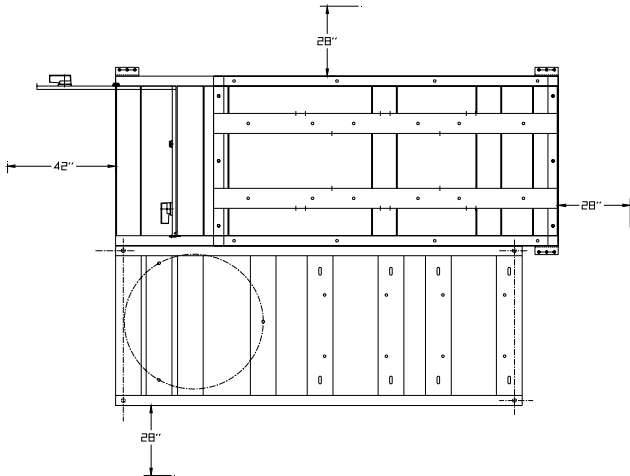

TOP VIEW

28" MINIMUM CLEARANCE FOR EASE OF MAINTENANCE

DIMENSIONS							
MODEL	DIM. A	DIM. B	DIM. C	DIM. D	DIM. E	DIM. F	DIM. G
MSH0504	66"	93"	77"	1"(F)	38"	1-1/2"(F)	86"
MSN0505	66"	93"	91"	1-1/2"(F)	73"	2"(F)	86"
MSD1504	66"	93"	77"	1"(F)	38"	1-1/2"(F)	86"
MST1005	66"	93"	91"	1"(F)	38"	1-1/2"(F)	86"
MST1505	66"	93"	91"	1-1/2"(F)	73"	2"(F)	86"
MSQ1005	66"	93"	91"	1"(F)	73"	2"(F)	86"
MSQ1505	66"	103"	91"	1-1/2"(F)	73"	2"(F)	100"

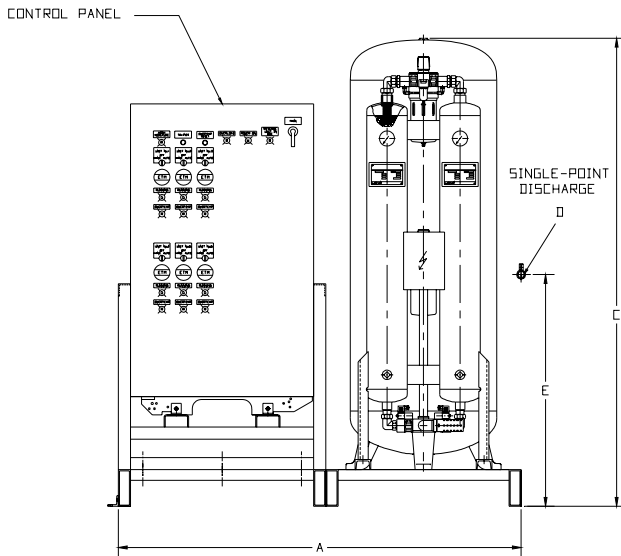

FRONT VIEW

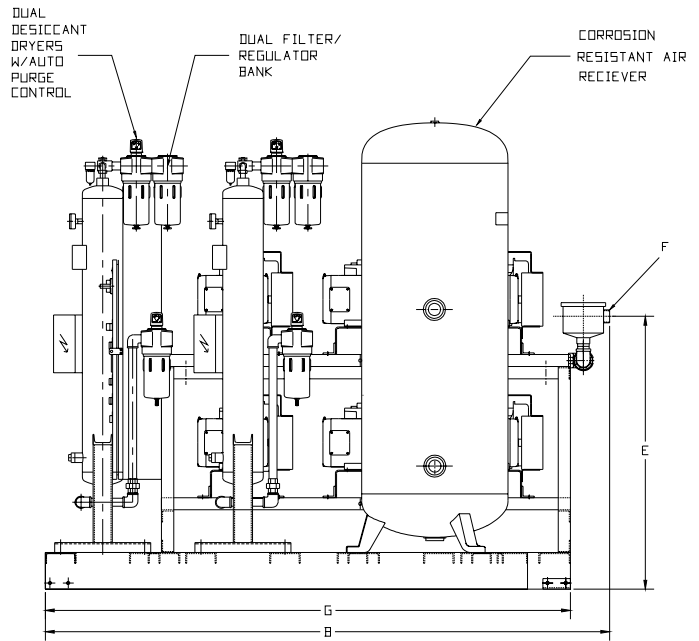

MEDICAL SCROLL AIR COMPRESSOR SYSTEM - TECHNICAL DATA							
MODEL	TANK SIZE	BTU/HR <sup>1</sup>	dB(A) <sup>2</sup> LEVEL	SYSTEM F.L.A.			WEIGHT Lbs.
				208V	230V	460V	
MSH0504	120 gal.	55,525	77	82.2	79.2	39.6	3,550
MSN0505	200 gal.	88,840	78	123.3	118.8	59.4	4,800
MSD1504	120 gal.	33,315	75	82.2	79.2	39.6	3,550
MST1005	200 gal.	44,420	76	82.2	79.2	39.2	4,600
MST1505	200 gal.	66,630	78	123.3	118.8	59.4	4,800
MSQ1005	200 gal.	66,630	78	109.6	105.6	52.8	5,050
MSQ1505	200 gal.	99,945	80	164.4	158.4	79.2	5,750

1) - BTU/HR is shown with reserve compressor module(s) on standby

2) - dB(A) is shown with reserve compressor module(s) on standby